

Fixing Instructions

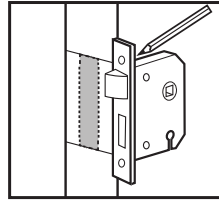

3 Lever Mortice Sashlock and Bathroom Mortice Lock

1. Position lock centrally on door and mark off body on the edge and both faces of door. Cut slot to suit lock ensuring a snug fit.



2. Insert lock and mark position of front faceplate recess.

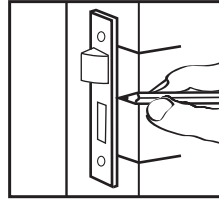

3. Using lock as template, mark off positions of keyhole and follower. Drill and cut on both sides of door. Insert lock, position face plate and fasten with screws provided and test operation of lock and latch.

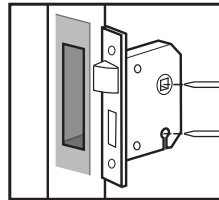

4. With door open, turn key to locked position. Close door onto frame and mark positions of 'Dead Bolt' and 'Latch Bolt'.

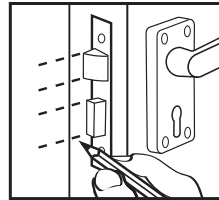

5. Mark out and cut slot in frame to accommodate flat strike plate. Fix the plate, recess flush with frame if required. Part secure plate initially to test lock operation. Complete fixing.

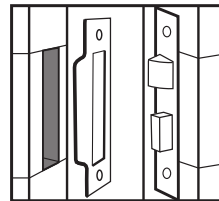

Instructions for reversing the bolt (if applicable)

- Remove 2 screws from the latch bolt and pull out latch bolt
- Reverse the bolt and place back into lock case
- Re-secure the 2 screws into the latch bolt

Sterling Locks Limited

Leeds Bradford Airport Industrial Estate
Harrogate Road, Yeadon, Leeds LS19 7WP

www.sterlinglocks.com

